



55, Hawthorne Crescent, Greenwich, London, SE10 9GA
£2,800 Per month



55, Hawthorne Crescent, Greenwich, London, SE10 9GA

£2,800 Per month

Spacious, split level 3 bedroom, 2 bathroom maisonette in excellent condition close to Greenwich Park and all the local amenities that Greenwich has to offer.

With a private patio garden and its own street level entrance, this property is perfect for a family or sharers due to the amount of space available.

Offered furnished and available now.

There is currently scaffolding on the building as they undertake repairs on properties above. The scaffolding currently restricts use of the garden but will be removed in Q1 2026.

Description

Spacious , split level 3 bedroom, 2 bathroom maisonette in excellent condition close to Greenwich Park and all the local amenities that Greenwich has to offer.

With a private patio garden and its own street level entrance, this property is perfect for a family or sharers due to the amount of space available.

Offered furnished and available now.

There is currently scaffolding on the building as they undertake repairs on properties above. The scaffolding currently restricts use of the garden but will be removed in Q1 2026.

Situation

Walking distance to local shops, leisure amenities and transport links into Central London and beyond.

Furnished

Council Tax Band: E

Available: 31st October 2025

Floor Plans

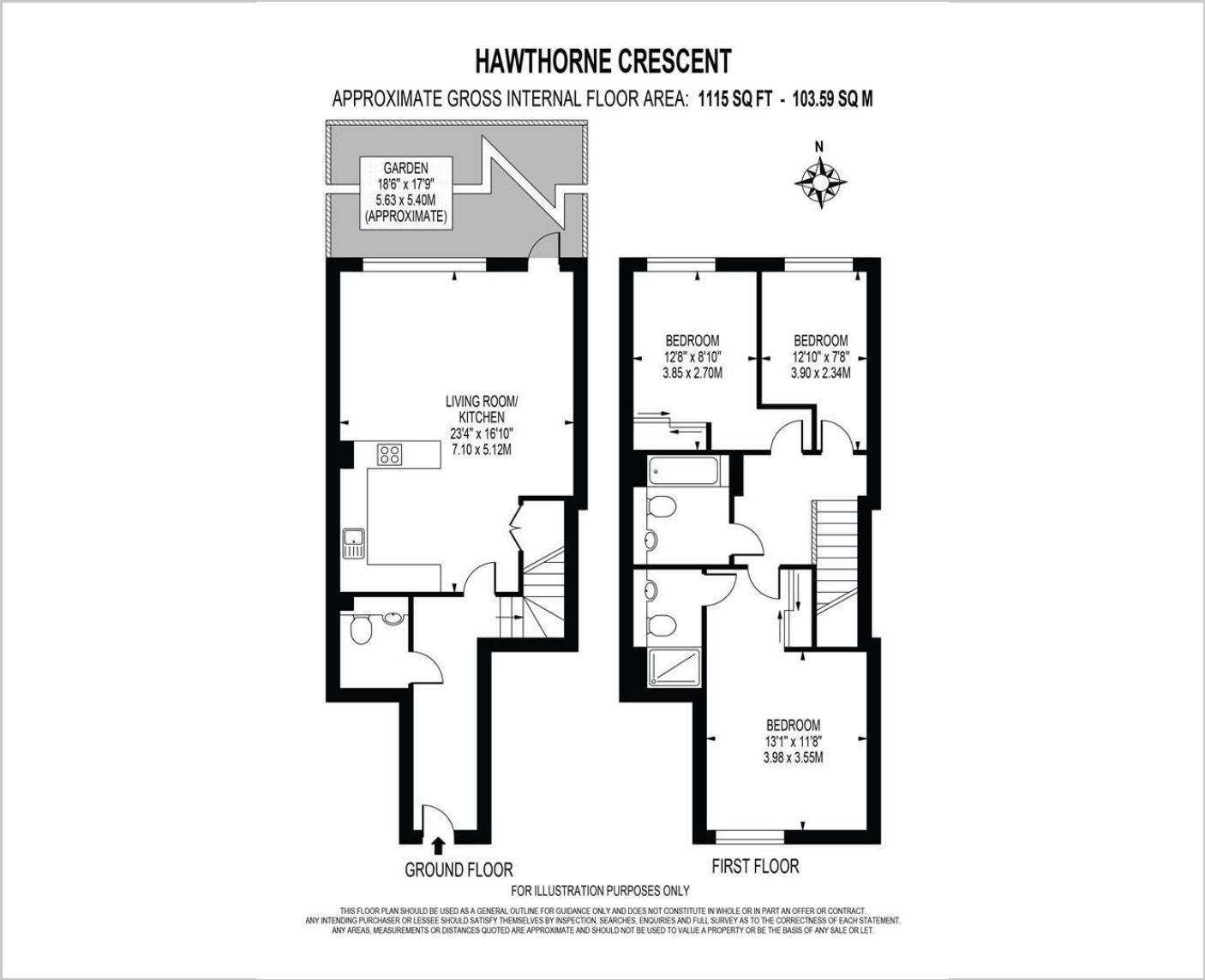

Area Map

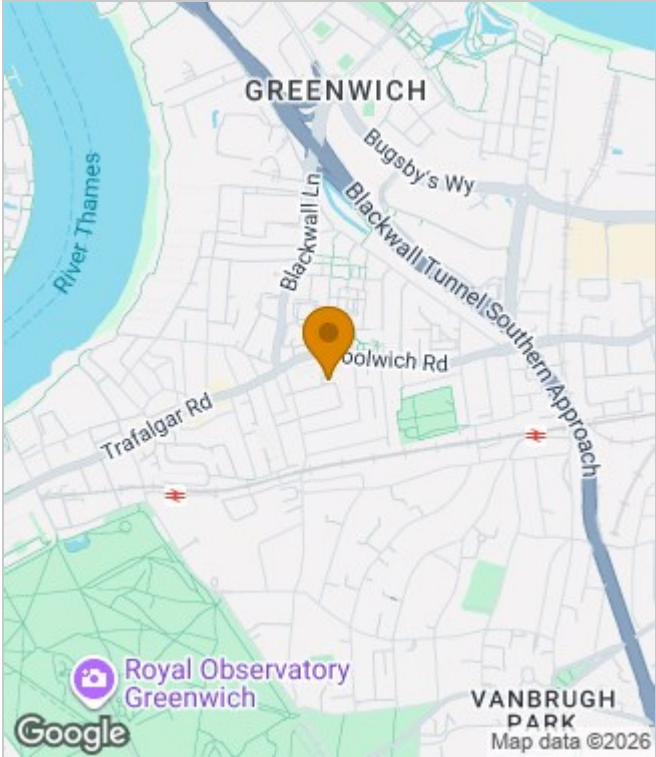

Energy Performance Graph

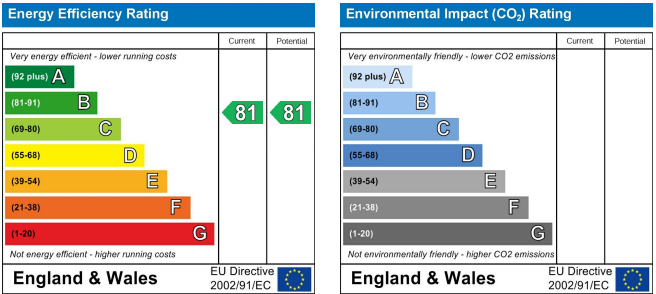

These particulars, whilst believed to be accurate are set out as a general outline only for guidance and do not constitute any part of an offer or contract. Intending purchasers should not rely on them as statements of representation of fact, but must satisfy themselves by inspection or otherwise as to their accuracy. No person in this firms employment has the authority to make or give any representation or warranty in respect of the property.